



who

Designer Vanessa Francis, Vanessa Francis Design

where

Oakville, Ont.

problem

The U-shaped kitchen with a separate eating area failed to offer enough space for the homeowners - a busy professional couple with two young boys - to cook together.

solution

Vanessa gutted the kitchen and got rid of the dining area, which allowed her to create a more open and efficient room with extra counter space and improved storage.

floor plan  
180 sq. ft.

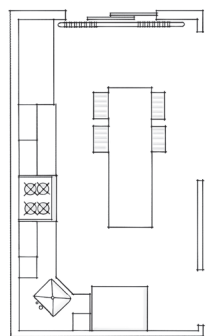

# fresh TIMELESS

← A pantry wall with two-foot-deep storage is made up of bottom drawers, two tall cupboards with rollout shelves and top cupboards for big bulky items and large serving pieces.



In a month-long overhaul, a 15-year-old kitchen gets a necessary facelift with a soothing palette and playful details, thanks to designer Vanessa Francis.

TEXT LAURA MUIR | PHOTOGRAPHY STEPHANI BUCHMAN



The decorative mesh-pannelled cabinet doors evoke a homey farmhouse look and add interest.

The stools, upholstered in easy-to-maintain outdoor fabric, complement the fresh white, grey and blue palette.

### • the look •

With classic recessed-panel cabinetry and a palette of white, grey and blue, the kitchen went from builder-basic to timeless, pretty and fresh.

### • the layout •

Adding a long island created a galley-style kitchen. "The big question was where to put the sink," says Vanessa. "Since the homeowner didn't want a sink in the island - because it would have attracted more mess - we put it in the corner, which was a good solution for her."

### • the extras •

The island includes an eating area, which takes the spot of the kitchen table, and comfortably accommodates this family of four. Details like the Moroccan-style glass backsplash and decorative mesh-pannelled cabinet doors add a distinctive quality.

### • the materials •

White-painted maple cabinetry with recessed-panel doors; off-white engineered quartz countertops; white glass mosaic backsplash tiles; oak hardwood floors; chrome pendant lights; satin nickel hardware; stainless steel appliances.



With its curvaceous lines and luminous quality, the Moroccan-style glass-tiled backsplash lends prettiness and elegance to the space.

GET THE  
**LOOK**  
fresh timeless

► Polished nickel Harmon **PENDANT LIGHT**, 15", \$469 US, Restoration Hardware, rh.com.



▲ Glazed porcelain mosaic Morocco **TILE** in Blanco Glossy, \$21 per sq. ft., Creekside Tile, creeksidetile.com.



◀ Rayon blend Lucid Sky **FABRIC** in Cove, \$128 per yard, through designers, Robert Allen, robertalldesign.com.



▼ Covington Blue HC-138 **WALL PAINT**, Benjamin Moore, benjaminmoore.ca.

► Cisco Home Banquito **COUNTER STOOL**, from \$1,225, Elte, elte.com.

